

FocusTest™ Series

Diode Laser Unmounted Bar Test System



Features

- High repeatability of tests
- Stable and reliable
- Low damage to diode laser chips
- QCW operation mode

Applications

- Automatic fast testing of unmounted bars
- Measurement of LIV, spectrum and far field features of emitters on unmounted chips

Product Dimensions (mm)

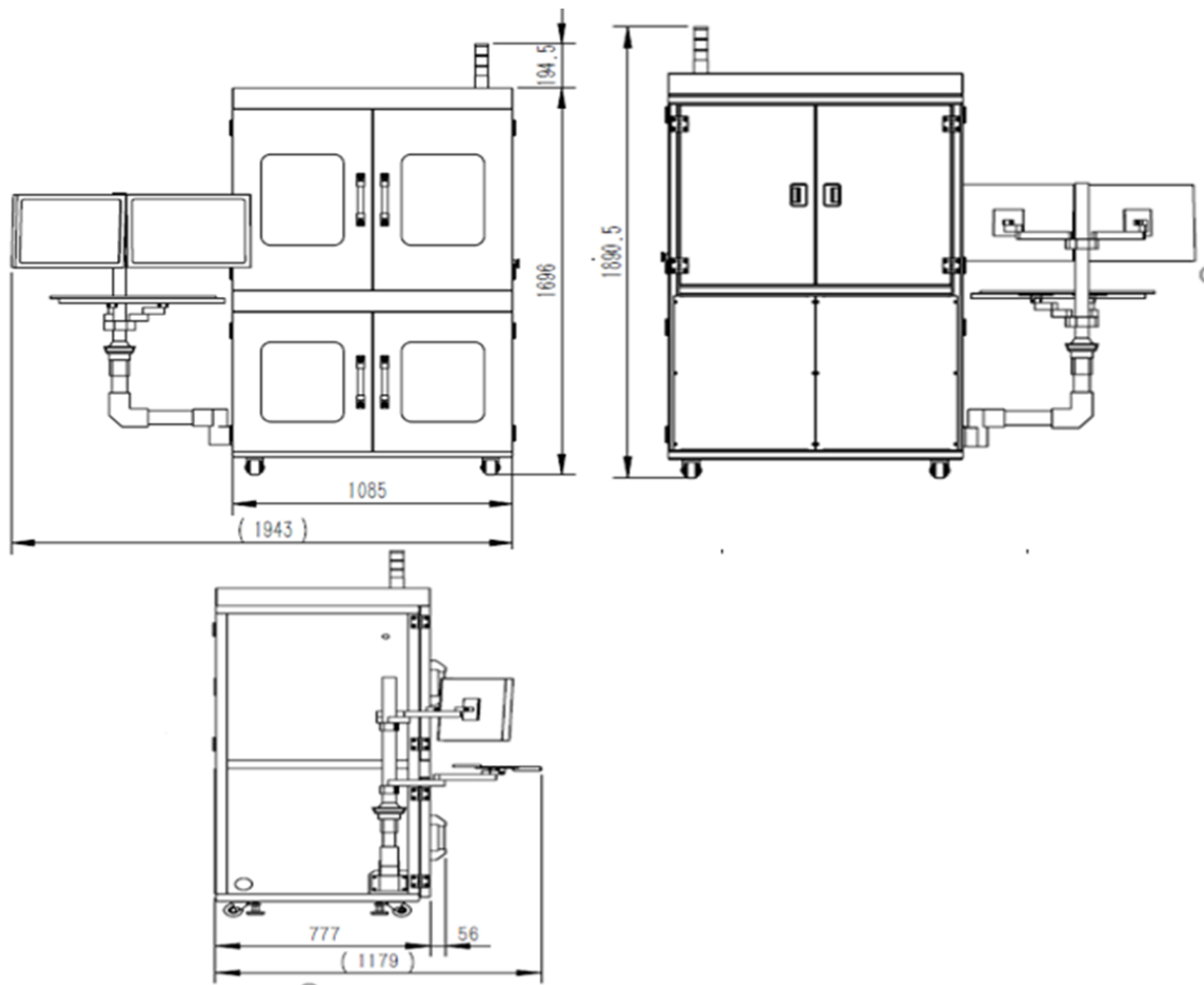

Remark: The structure drawing is for reference only. Please feel free to contact us for any special requirements.

Product Specifications

Product Code

Part No. FL-CT-LIV-FF

General Data	Unit	Value
Dimensions (Width x Depth x Height)	mm	1100 x 800 x 1900
Weight	kg	< 300

Testing Items

LIV	Output power, operating voltage, operating current, threshold current, electro-optical efficiency, slope efficiency
Spectrum	Peak wavelength, central wavelength, centroid wavelength, FWHM, spectral width 90% Energy

Testing Capabilities

Divergence Angle Range	°	≤ 120
Divergence Angle Accuracy	°	± 0.2
Operation Current (QCW, μs level)	A	≤ 40
Testing Spectrum Range	nm	600 ~ 1000
Testing Spectrum Resolution	nm	0.12

Temperature Control

Range	°C	15 ~ 80
Accuracy	°C	± 0.2

Chiller

Range	°C	15 ~ 30
Cooling Water Pressure	bar	3.5
Accuracy	°C	± 1

Software

System Software Functions	Automatically test power, voltage, current, spectrum, temperature and other parameters; Automatically generate profiles and reports
---------------------------	---

Communication Interface

Computer Interface	USB2.0 RS232
--------------------	--------------

Electric Parameter

Power Supply	AC 220V / 50Hz
--------------	----------------

